

ŘEZ A - A 3,50m

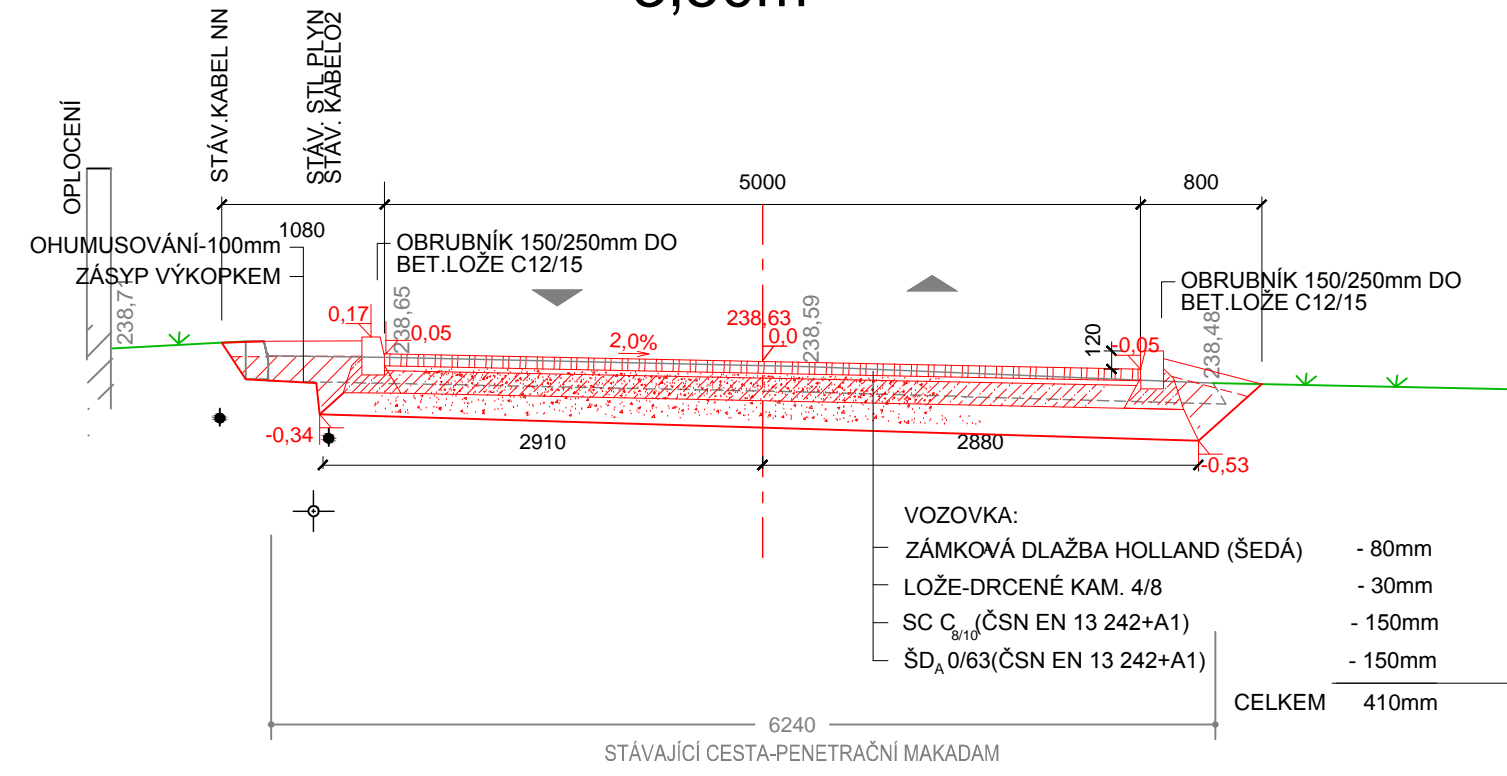

ŘEZ C - C 64,30m

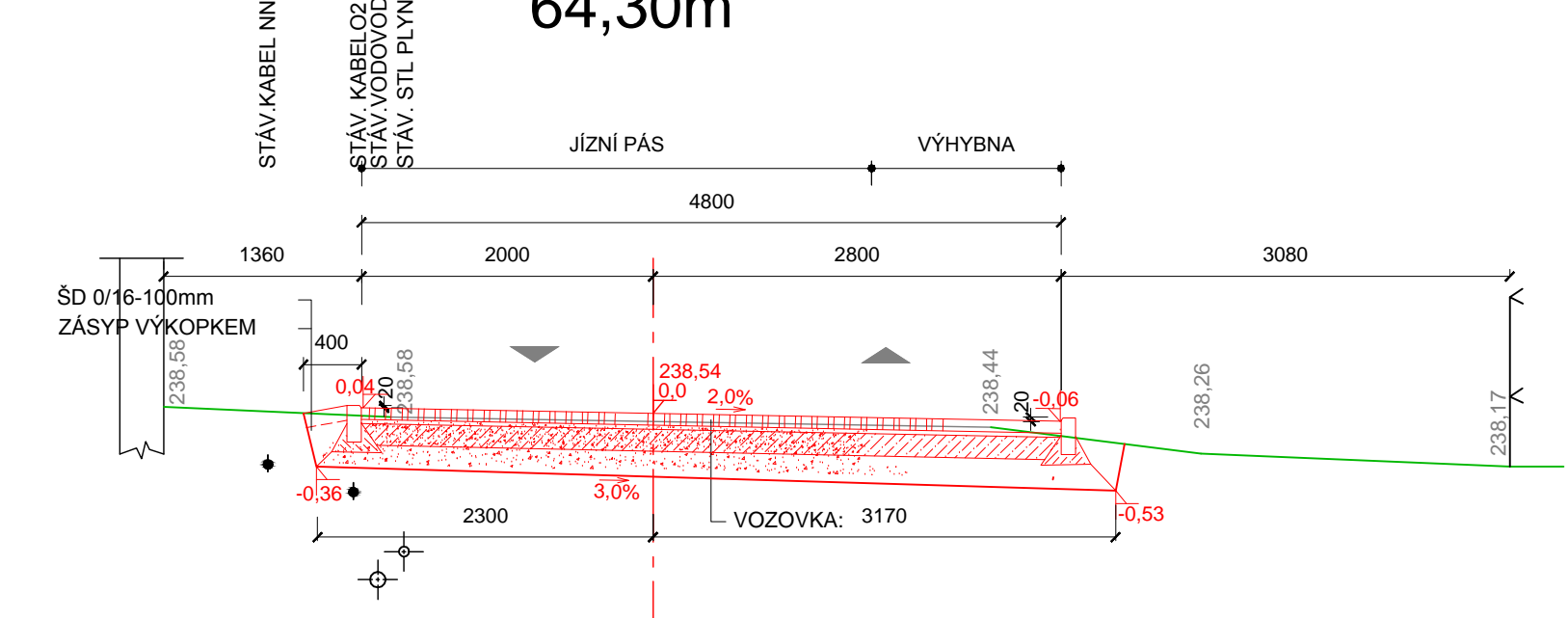

ŘEZ E - E 158,00m

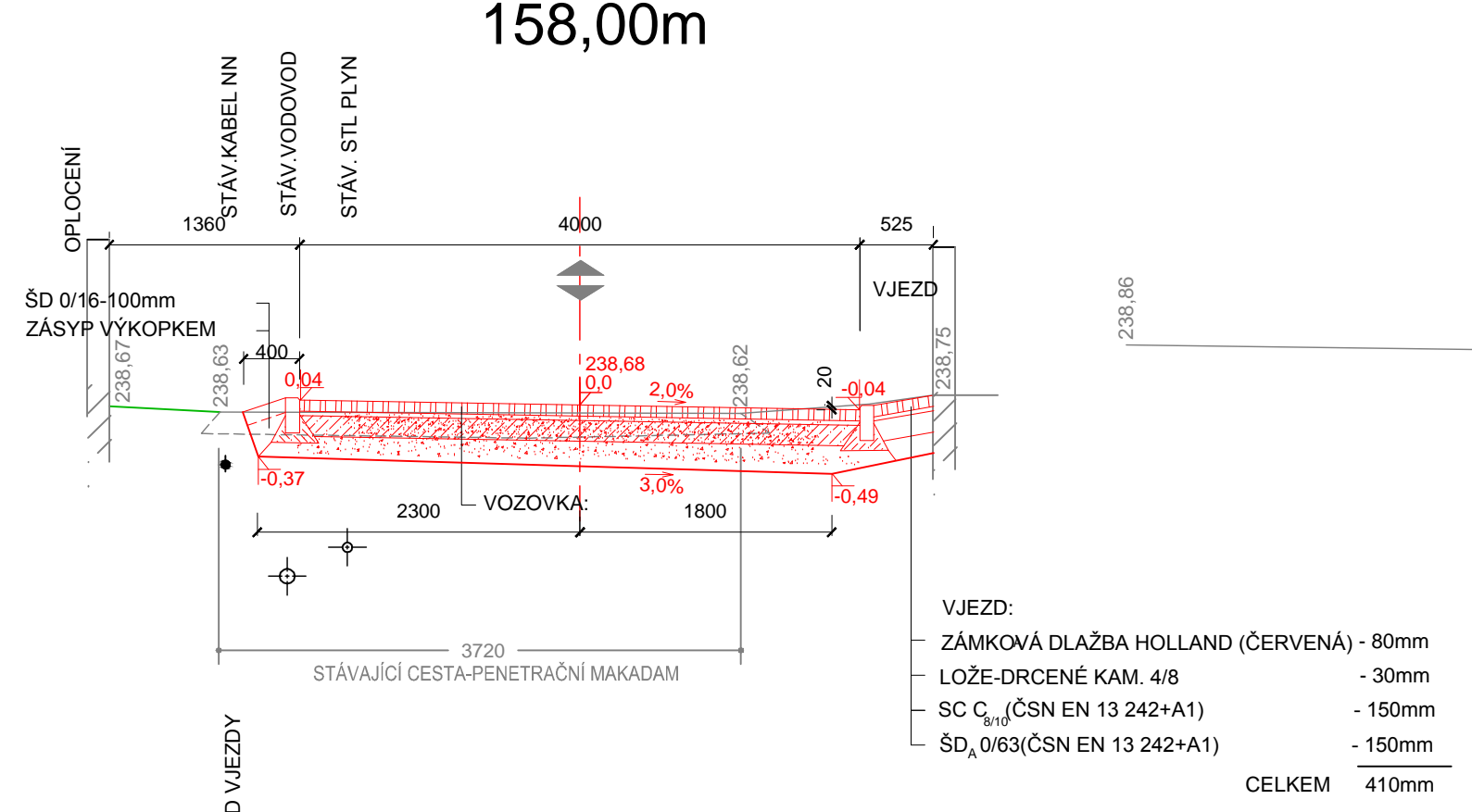

ŘEZ H - H

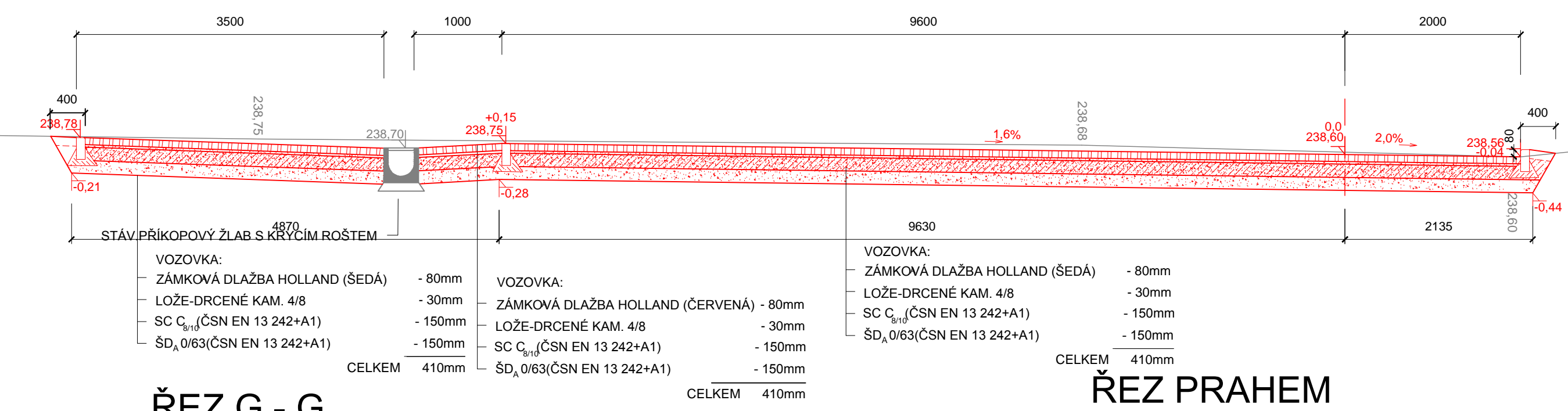

ŘEZ B - B 40,20m

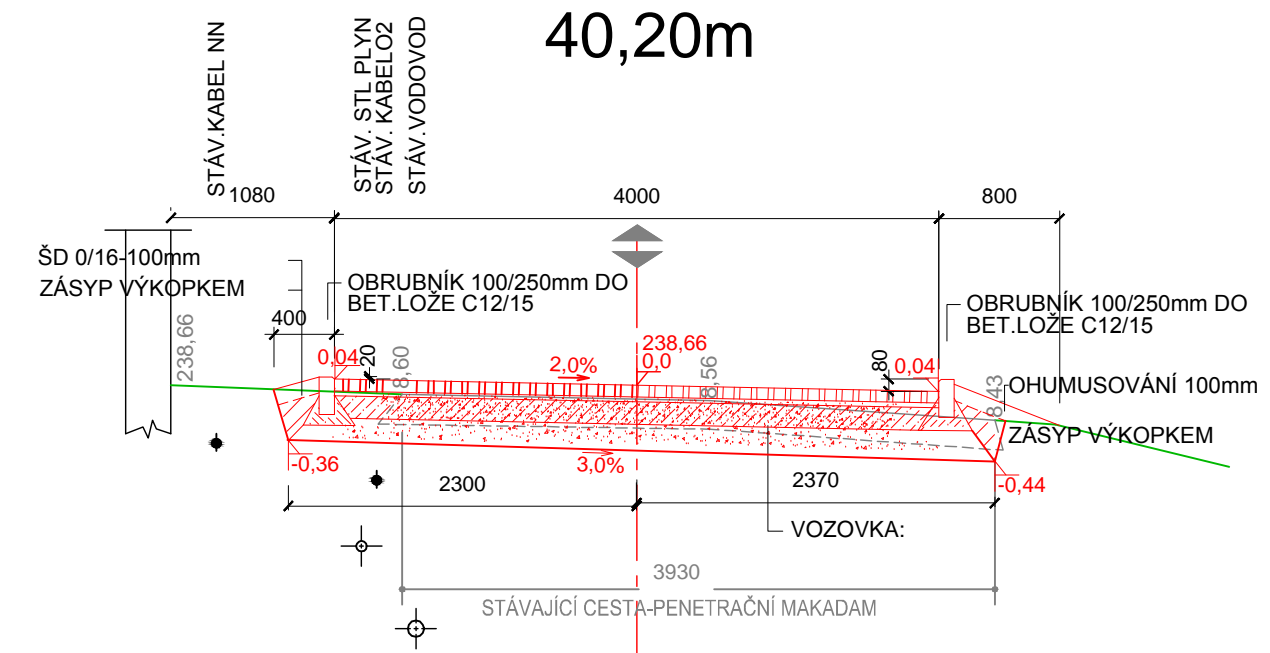

ŘEZ D - D 94,40m

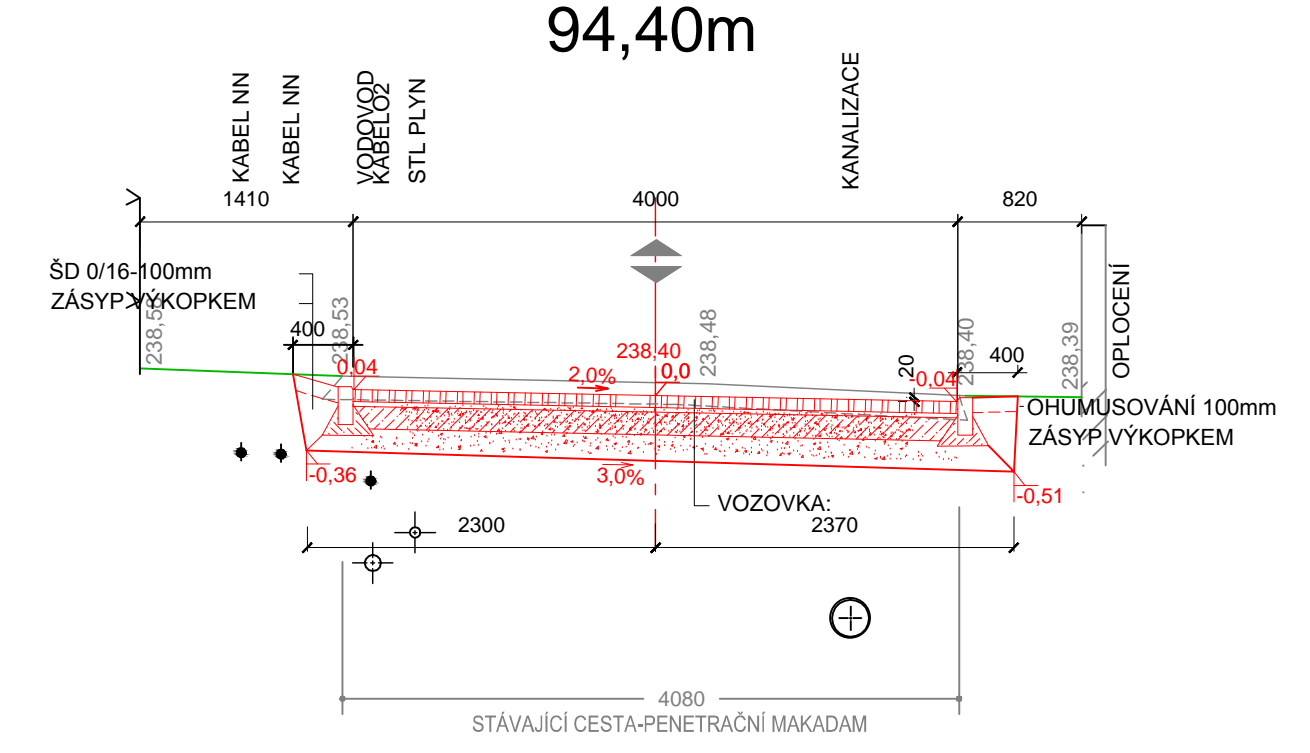

ŘEZ F - F 207,20m

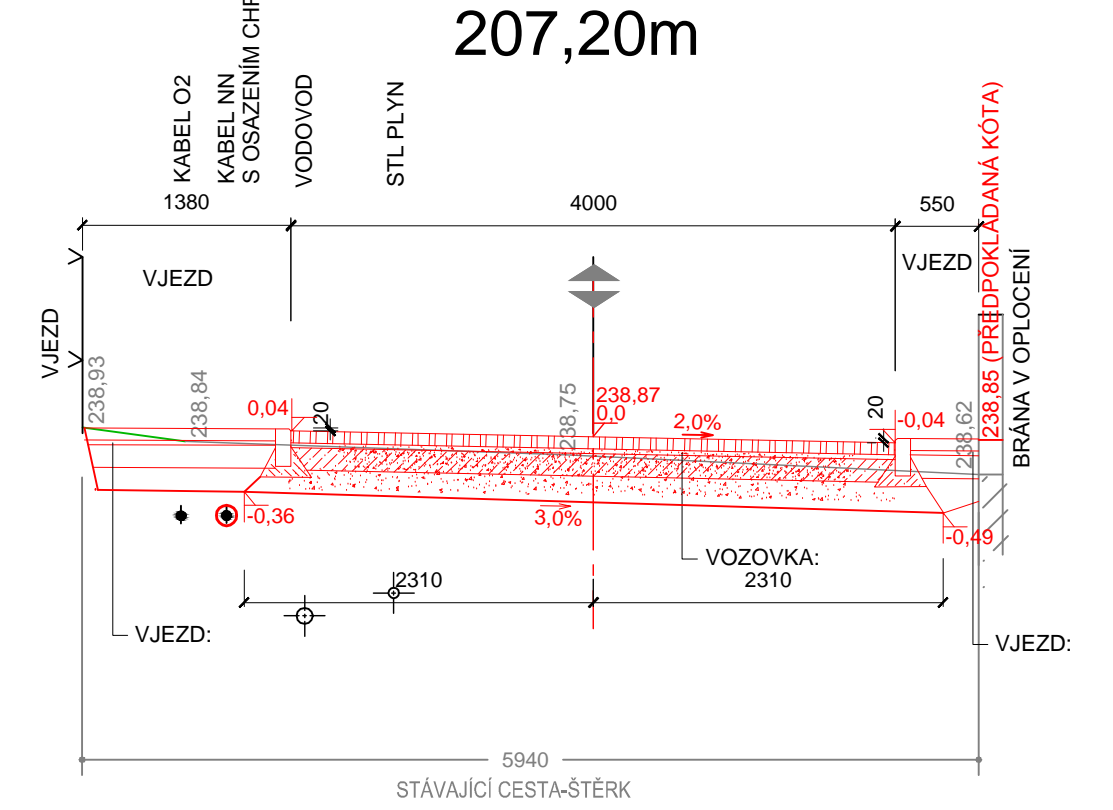

ŘEZ G - G

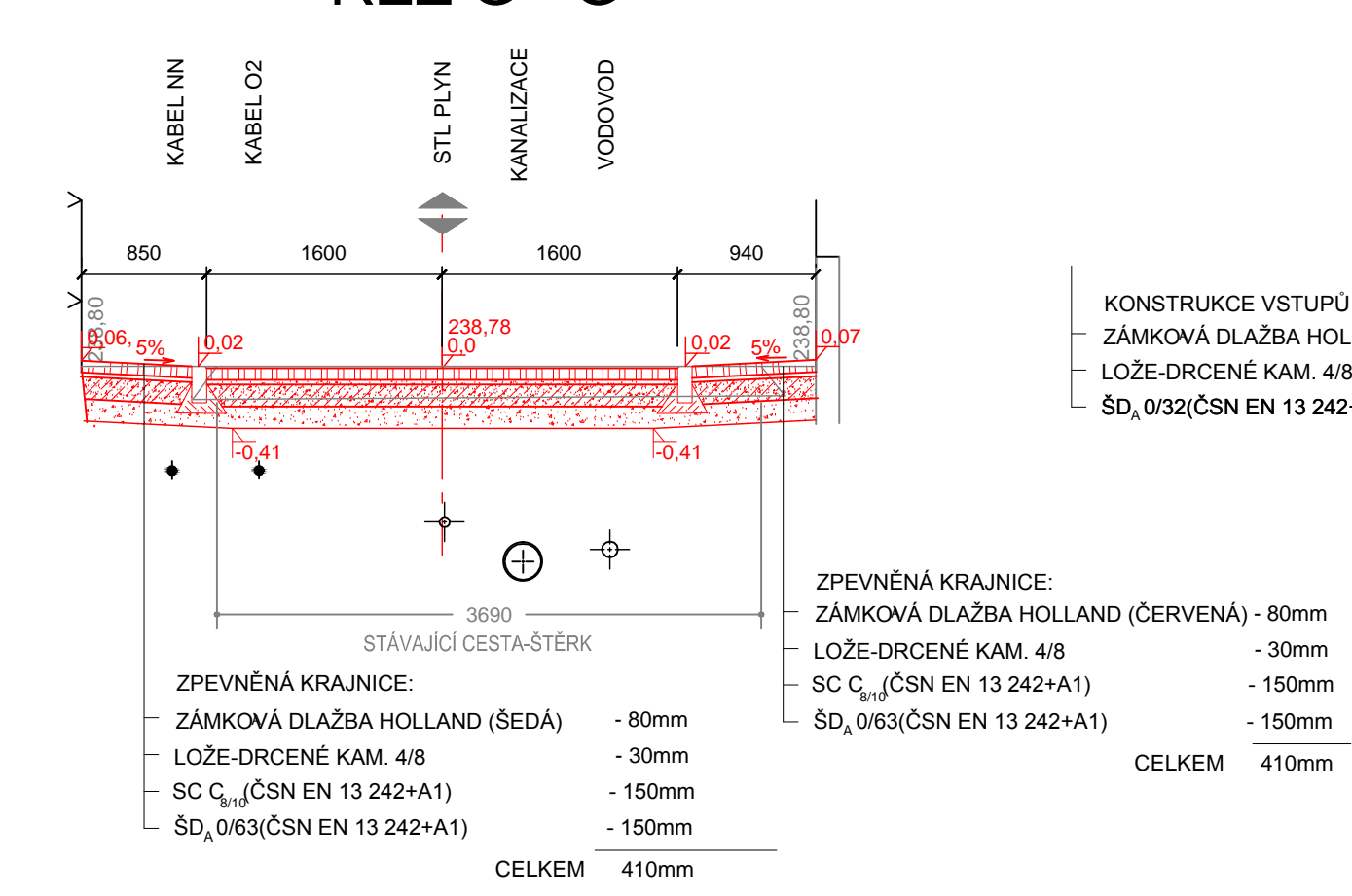

ŘEZ PRAHEM

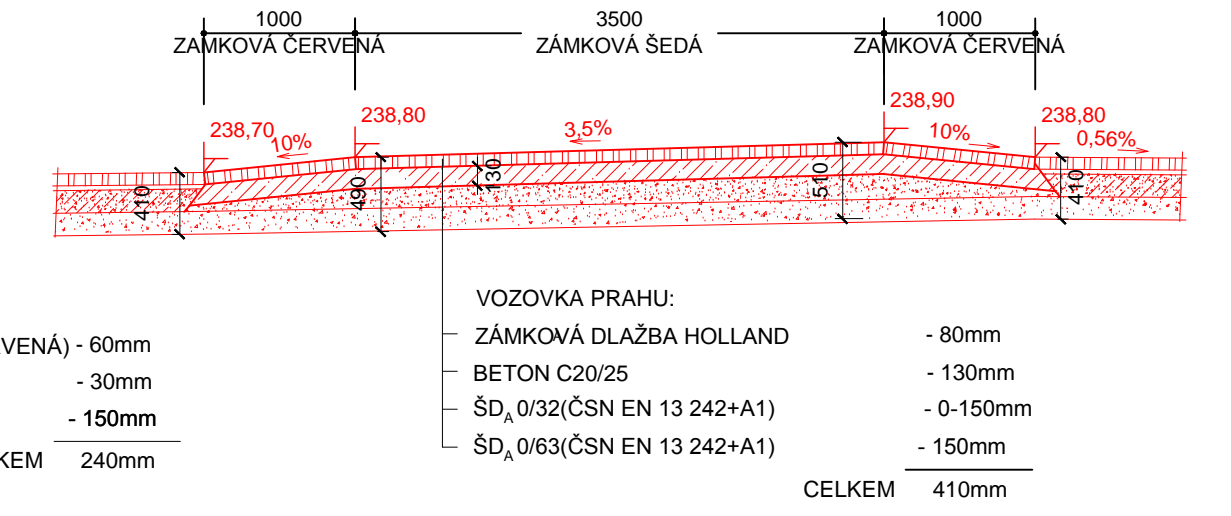

VYPRACOVAL	ZODP.PROJEKTANT	HIP	SOUBOR	ZAK.ČÍSLO		
ING.PAVEL KLÁSEK	ING.PAVEL KLÁSEK			2016042		
INVESTOR:	OBEC TOVĚŘ			DATUM	09/2017	
ZAKÁZKA	TOVĚŘ-ZA HUMNY STAVEBNÍ ÚPRAVA KOMUNIKACE			FORMÁT	5A4	
PRÍLOHA				PŘÍČNÉ ŘEZY		
				Č.PŘÍLOHY	C4	
					Č.KOPIE	
					MĚŘÍTKO	1:50